

**MOTORISED ALUMINIUM ROLLER SHUTTER  
(SIMU MOTOR) ALTERNATIVE COLUMN DETAILS**

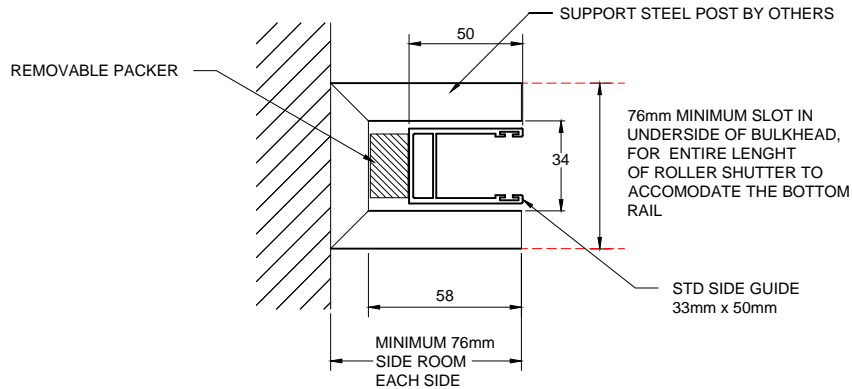

**IMPORTANT**  
WHEN USING THIS DETAIL, THE BULKHEAD MUST BE SUFFICIENTLY STRUCTURAL TO SUPPORT THE WEIGHT OF THE MOTORISED DOOR

WHEN USING THIS DETAIL, THE MOTOR MANUAL RELEASE CAN ONLY BE LOCATED IN THE BULKHEAD - IT CANNOT BE MOUNTED WITHIN THE CAVITY OF THE STEEL POST DUE TO INSUFFICIENT SPACE

**MOTORISED ALUMINIUM ROLLER SHUTTER  
(SIMU MOTOR) 4 - PIN PLUG ASSEMBLY**

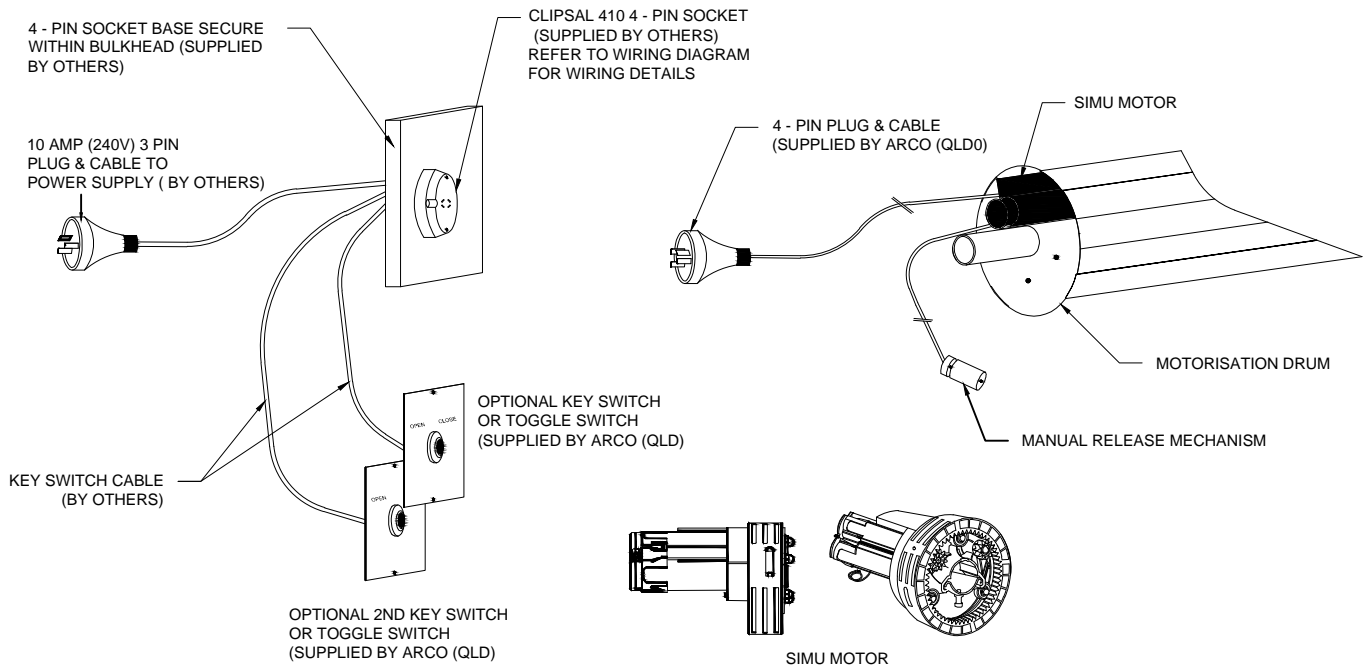

ARCO (QLD) has a continuous program of product development and reserves the right to change specifications at any time without notice

PLEASE NOTE: 1. IF INADEQUATE ACCESS IS PROVIDED ARCO (QLD) WILL NOT BE HELD RESPONSIBLE FOR MAINTENANCE OR THE COSTS INCURRED TO CREATE ADEQUATE ACCESS  
2. ARCO (QLD) SIMU MOTORISED SHUTTERS MUST BE INSTALLED TO STRUCTURAL SUPPORTS, I.E. RHS STEEL POST, CORE FILLED MASONRY, TILT UP CONCRETE PANELS  
3. ALL STRUCTURAL SUPPORTS FOR BRACKETS AND SIDE GUIDES TO BE PROVIDED BY OTHERS  
4. ALL WIRING AND SETTING OF LIMITS BY OTHERS (OPTIONAL). UNLESS INCLUDED IN QUOTE