

# Q100

## Roll Formed Roller Shutter

### Features:



Secure and Robust



Quieter Operation



Easily installed  
and maintained



Cyclone Rated to comply  
with AS/NZS  
1170.2-2011



Short Lead Times



## Q100 - Roll Formed Roller Shutter

Q100 Roll Formed Roller Shutter with 100mm Galvanized Steel material as Manufactured by ARCO (Qld).

The Heavy Duty steel slat is designed to withstand the wear and tear of industrial and commercial applications with minimal maintenance. The rolled slat can be replaced individually should the damage occur.

ARCO (Qld) Steel Roller Shutters are purposely built with Guide Channel that has Nylon Rubber to minimize the noise that comes from the interlocking slats. Q100 Steel Roller Shutters can be Hand operated or Electric operated. Each slat is fitted with nylon end clips to reduce the lateral movements and ensure smooth operation for the life of the door.

With our new standard range of quality Australian made Colorbond steel now stocked in our factories, ARCO can provide best in class lead times from measure to final installation and remove the need for costly powder coating.

### Colorbond® Standard Colours (available in 1.0mm):



Ironstone®



Shale Grey™



Monument®



Surfmist®



Duralloy Powdercoat  
Colours also available.

### Unique Features:



Guide with silencing strip



Spring and Springless Option

Australian Made

[arcoaustralia.com.au](http://arcoaustralia.com.au)

QLD: (07) 3807 5364 | WA: (08) 9309 1520

# Features and Benefits

## Recommended Specification

Q 100 Roll Formed Roller Shutter with 100mm Galvanized Steel materials as manufactured by ARCO (Qld).

## Design Features

The Heavy Duty steel slat is designed to withstand the wear and tear of industrial and commercial applications with minimal maintenance. The rolled slat can be replaced individually should damage occur.

ARCO (Qld) Q100 Steel Roller Shutters has a purposely built Guide Channel that has Nylon Rubber to minimize the noise that comes from the interlocking slats. Q100 Steel Roller Shutters can be Hand Operated or Electric Operated. Each slat is fitted with nylon end clips to reduce the lateral movements and to ensure smooth operation for the life of the door.

For Cyclonic conditions, high strength wind locks and guides are designed to prevent the curtain from blowing out of the guide rail. Wind locks can be every 2nd or every 4th slat or the entire door depending on the location and function.

## Standard Curtain

The Series Q100 are available in 0.8mm and 1mm thick-ness. 1.2mm slat is also available

Note: Recommended maximum width is 10 metres. Refer to ARCO (Qld) Counterweight products for larger single span openings.

## Curtain Alternatives

**Double D Slotted Slats (Ventilation)** Any number of the slats can be punched with 60mm wide x 40mm high double slots. D-slotted provides 19% of ventilation **MULTI HOLE Slats** – The slats can also be continuously perforated with 2.41mm diameter holes at 3.66mm staggered centres prior to rolling (this allows maximum air flow the holes are over the entire surface area of the slat). Multi-hole provides 40% ventilation

These perforations cover 40% of the slat surface. As the multi hole process removes a substantial portion of the slats zinc coating, we do not recommend this slat be used in corrosive environments, or in any reasonable proximity to salt water.

## Roller Drum

The roller drum is a robust seamless steel tube encasing the shaft and helical counterbalance spring (for manually operated). The end caps and roller bearings are designed to give smooth operations. Springs are available in both manual and motorised

sprung drum. ARCO also manufactures non-balanced drum (spring-less drum).

## Guide Channels

2mm galvanized steel is roll formed with the nylon rubber to make a noticeably quiet steel Roller Shutter when opens and closes on a 100mm x 48mm guide channel. Wind-locked guide, 103x48 channel with 20x10 steel flat bar welded on the inside. HD wind-locked guide, designed to suit curtain with wind-locked every slat. Structure consists of 125x125 Equal Angle and 20x10 Flat bar welded to 125x75 RHS.

## Support Bracket

The support brackets are fabricated from mild steel plate and designed to be fitted to a solid fixing point of adequate strength to support the weight of the door and any wind loading that may be required (adequate fixing points to be supplied by others).

## Bottom Rail

The Bottom Rail is roll formed from 3mm galvanized steel to make a 50mm x 50mm angle. This angle is securely fixed to the front of the slat (bottom of angle protrude to inside of opening). This can also be Aluminium Bottom Rail. A 75x50 RHS bottom rail is available. All of our bottom rails can be equipped with weather seal.

## Operation

**Hand Operation** – Small Roller Shutters with an area of 6 square meters maybe hand operated. Pull hook is provided for opening and closing the door. **Chain operation** - Manual Hoist supporting roller shutters with maximum door area of 25sqm.

**Electric Operated** – Motorization includes 1Hp motor incorporating a standard reversing contractor and an Up, Down, Stop button controller with a hand chain override in case of power failure. For Remote Control and other options, please contact ARCO (Qld). All wirings will be by others.

## Locking Operation

**Hand Operated** – will have Sliding Shoot bolts.

**Electric Operated** – will be secured by electrical motors and controls.

Sliding shoot bolts for Hand Operated and Chain Operated.

## Finish

Standard finish is Galvanised Curtain and Guides with all other exposed parts prime painted. Optional finishes to Slats only is powder coating. ColorBond finish in limited colour range.

# Q100 Specifications

Q100 BUNDLE DIAMETER & MINIMUM REQUIRED HEADROOM

DRUM ø	165	165	165	165	165	165	165	168
HEIGHT	2000	3000	4000	5000	6000	7000	8000	9000
WIDTH	5000	5000	5000	5000	5000	5000	5000	5000
BUNDLE ø	285	345	405	465	525	585	645	708
HEADROOM	543	573	603	633	663	693	723	754

DRUM ø	165	165	165	165	168	168	168	168
HEIGHT	2000	3000	4000	5000	6000	7000	8000	9000
WIDTH	6000	6000	6000	6000	6000	6000	6000	6000
BUNDLE ø	285	345	405	465	528	588	648	708
HEADROOM	543	573	603	633	664	694	724	754

DRUM ø	165	168	168	168	168	219	219	N/A
HEIGHT	2000	3000	4000	5000	6000	7000	8000	9000
WIDTH	7000	7000	7000	7000	7000	7000	7000	7000
BUNDLE ø	285	348	408	468	528	639	699	N/A
HEADROOM	543	574	604	634	664	720	750	N/A

DRUM ø	168	219	219	219	219	N/A	N/A	N/A
HEIGHT	2000	3000	4000	5000	6000	7000	8000	9000
WIDTH	8000	8000	8000	8000	8000	8000	8000	8000
BUNDLE ø	288	399	459	519	579	N/A	N/A	N/A
HEADROOM	544	600	630	660	690	N/A	N/A	N/A

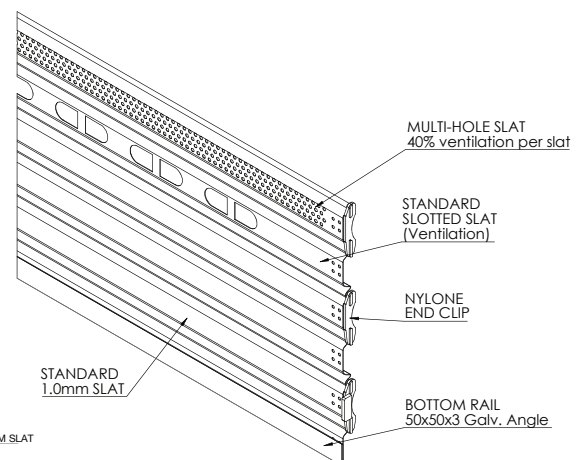
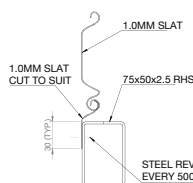
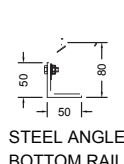
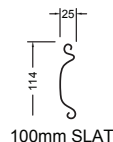
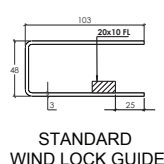
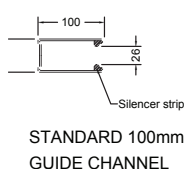

ARCO (QLD) has a continuous program of product development and reserves the right to change specifications at any time without notice.